

OT-TB34 Installation Guide

The OT-TB34 is an exclusive tear bar for the TM-C3400 to cut wrist band rolls from General Data Company, Inc. (GD wristbands) manually at the perforation. This guide explains how to install the tear bar in the TM-C3400.

Installing the OT-TB34

Follow the steps below to install the tear bar on the paper ejection table.

Paper ejection table

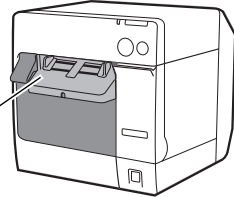

1. Unlock the paper ejection guide with a fine-tipped object.

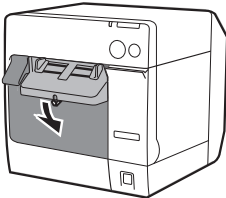

2. Slide the paper ejection guide to as narrow a position as possible.

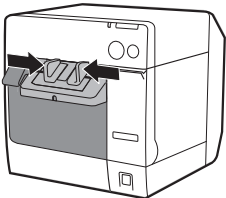

3. Pull the release lever to open the roll paper cover.

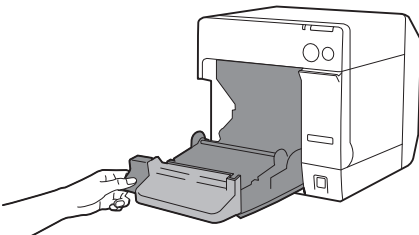

4. Insert two hooks of the tear bar into the groove on the far side of the paper ejection table.

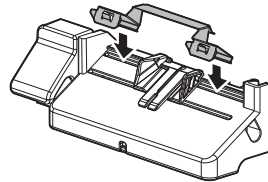

5. Insert the other two hooks into the groove on the near side.

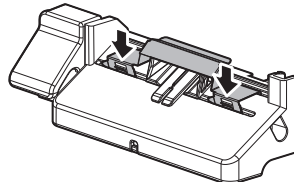

6. Make sure that the tear bar is fully inserted. If there is a gap between it and the paper ejection table, press the bar down to set it securely.

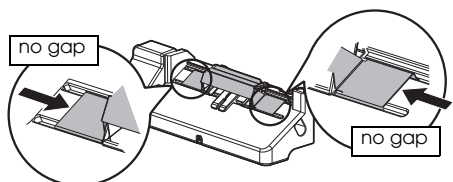

7. Slide the paper ejection guide to as wide a position as possible, and lock it.

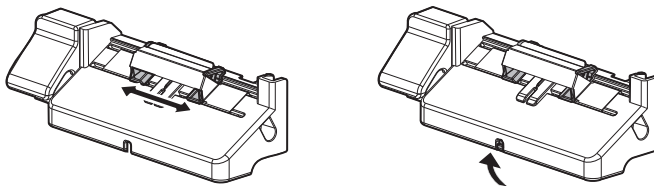

Setting the Printer Driver

The following driver setting is required to cut GD wristbands at the perforation with the tear bar, instead of cutting with the autocutter.

1. Select [No Auto Cut] and [Feed To Peel Off Position] in [Settings For Handling Media After Print] in the [General] tab of the printer driver.
2. Disable the Cut button in [Panel Button Settings] in the [Maintenance And Utilities] tab.
3. Click [OK] to complete the setting.

Installing GD Wristbands

1. Load the wrist band roll completely inside the printer with the printable side up (black marks down).
2. Pass the wrist band through the tear bar.

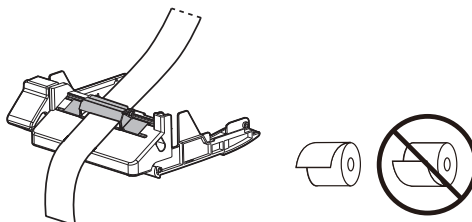

3. Close the roll paper cover with care to keep the wrist band through the tear bar.
4. The wrist band is fed automatically when the roll paper cover is closed or the printer is turned on.

For initial setting of the printer or details on making paper changes, see "Installing Paper" in the TM-C3400 User's Manual.

Note:

Pulling the wrist band horizontally when cutting it may misalign it from its correct printing position. Be sure to cut the wrist band while pulling it upward.

Cautions

Depending on the area, the interface cable may be included with the product. If so, use that cable. Seiko Epson Corporation shall not be held liable for any damage resulting from electromagnetic interference that occurs from the use of any interface cables other than those designated as Epson approved products.

EPSON is a registered trademark of Seiko Epson Corporation in Japan and other countries/regions. General Notice: Other product and company names used herein are for identification purposes only and may be trademarks of their respective companies.